

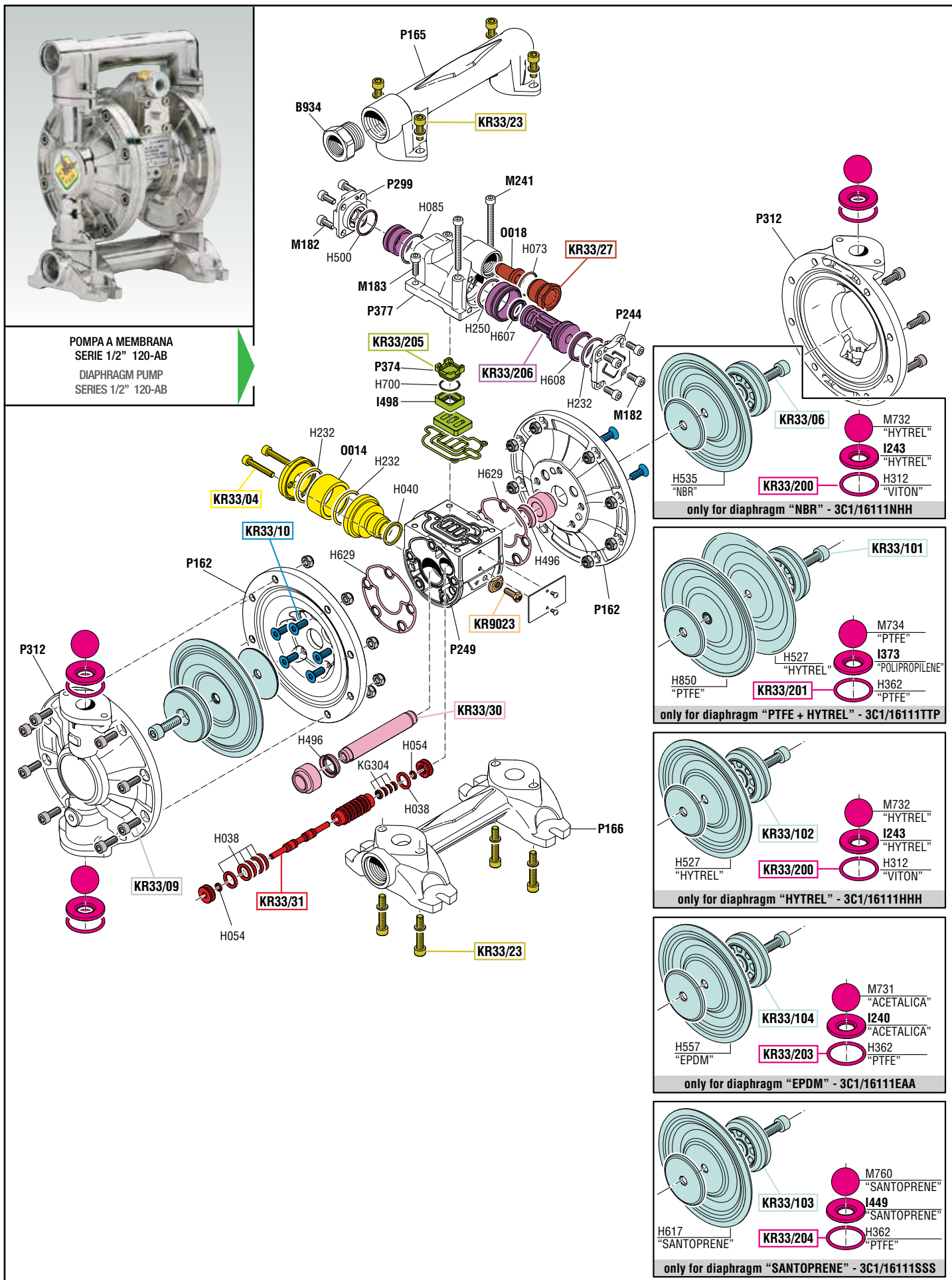

Art. 3C1/16111NHH Mod. AAB-12-N-60 - Art. 3C1/16111TTP Mod. AAB-12-T-50
 Art. 3C1/16111HHH Mod. AAB-12-H-60 - Art. 3C1/16111EAA Mod. AAB-12-E-60
 Art. 3C1/16111SSS Mod. AAB-12-S-60



VISTA ESPLOSA - EXPLODED VIEW





GUIDA RICAMBI - SPARE PARTS GUIDE

KIT RICAMBI

OGNI KIT SOTTO RIPORTATO COMPRENDE I RICAMBI EVIDENZIATI CON LO STESSO COLORE E LE RELATIVE GUARNIZIONI. QUESTI RICAMBI NON SONO FORNIBILI SEPARATAMENTE TRANNE QUELLI CODIFICATI.

SPARE PARTS KITS

EACH KIT SHOWN WITH THE SAME COLOR INCLUDES ALSO THE GASKETS. THE SPARE PARTS INCLUDED IN THE KIT CAN'T BE SUPPLIED SEPARATELY EXCEPT THOSE SHOWN WITH A PROPER CODE.

CODICE CODE	DESCRIZIONE DESCRIPTION	Q.TÀ QTY
KR33/06	GRUPPO MEMBRANE "NBR" DIAPHRAGM GROUP "NBR"	1
KR33/101	GRUPPO MEMBRANE "PTFE + HYTREL" DIAPHRAGM GROUP "PTFE + HYTREL"	1
KR33/102	GRUPPO MEMBRANE "HYTREL" DIAPHRAGM GROUP "HYTREL"	1
KR33/103	GRUPPO MEMBRANE "SANTOPRENE" DIAPHRAGM GROUP "SANTOPRENE"	1
KR33/104	GRUPPO MEMBRANE "EPDM" DIAPHRAGM GROUP "EPDM"	1
KR33/200	GRUPPO VALVOLE (3C1/16111NHH, 3C1/16111HHH) VALVE GROUP (3C1/16111NHH, 3C1/16111HHH)	1
KR33/201	GRUPPO VALVOLE (solo per 3C1/16111TTP) VALVE GROUP (only for 3C1/16111TTP)	1
KR33/203	GRUPPO VALVOLE (solo per 3C1/16111EAA) VALVE GROUP (only for 3C1/16111EAA)	1
KR33/204	GRUPPO VALVOLE (solo per 3C1/16111SSS) VALVE GROUP (only for 3C1/16111SSS)	1
KR33/04	SILENZIATORE MUFFLER	1
KR33/09	VITERIA FLANGE FLANGES SCREWS	1
KR33/10	VITERIA MOTORE MOTOR SCREWS	1
KR33/23	VITERIA COLLETTORI MANIFOLDS SCREWS	1
KR33/27	ENTRATA ARIA AIR INLET	1
KR33/30	GRUPPO ALBERO PISTONE PISTON SHAFT GROUP	1
KR33/31	GRUPPO PERNO PILOTA PILOT PIN GROUP	1
KR33/205	GRUPPO DISTRIBUTORE DISTRIBUTOR KIT	1
KR33/206	GRUPPO INVERTITORE AIR SWITCH KIT	1
KR9023	MESSA A TERRA GROUNDED	1

ELENCO RICAMBI FORNIBILI SINGOLARMENTE

LIST OF SPARE PARTS WHICH CAN BE SUPPLIED SEPARATELY

CODICE CODE	DESCRIZIONE DESCRIPTION	Q.TÀ QTY
B934	ADATTATORE M/F 3/4" ADAPTER M/F 3/4"	1
H700	GUARNIZIONE DISTRIBUTORE MOTORE ENGINE GASKET DISTRIBUTOR	1
I498	PARTE INFERIORE DISTRIBUTORE MOTORE BOTTOM ENGINE DISTRIBUTOR	1
M182	VITE INOX M45x12 STAINLESS STEEL SCREW M45x12	8
M183	VITE INOX M5x16 STAINLESS STEEL SCREW M5x16	2
M241	VITE INOX M5x50 STAINLESS STEEL SCREW M5x50	2
0014	SILENZIATORE MUFFLER	1
0018	FILTRO ENTRATA INLET FILTER	1
P162	FLANGIA INTERNA INTERNAL FLANGE	2
P165	COLLETTORE SUPERIORE SUPERIOR MANIFOLD	1
P166	COLLETTORE INFERIORE INFERIOR MANIFOLD	1
P244	COPERCHIO COVER	1
P249	CORPO CENTRALE CENTRAL BODY	1
P299	COPERCHIO COVER	1
P312	FLANGIA ESTERNA EXTERNAL FLANGE	2
P374	PARTE SUPERIORE DISTRIBUTORE MOTORE TOP ENGINE DISTRIBUTOR	1
P377	CORPO DISTRIBUTORE AIR DISTRIBUTOR BODY	1
H527	MEMBRANA "HYTREL" DIAPHRAGM "HYTREL"	2
H535	MEMBRANA "NBR" DIAPHRAGM "NBR"	2
H557	MEMBRANA "EPDM" DIAPHRAGM "EPDM"	2
H617	MEMBRANA "SANTOPRENE" DIAPHRAGM "SANTOPRENE"	2
H850	MEMBRANA "PTFE" DIAPHRAGM "PTFE"	2
H312	GUARNIZIONE O-RING "VITON" O-RING "VITON"	4
H362	GUARNIZIONE O-RING "PTFE" O-RING "PTFE"	4
I240	SEDE VALVOLA "ACETALICA" SEAT VALVE "ACETALICA"	4
I243	SEDE VALVOLA "HYTREL" SEAT VALVE "HYTREL"	4
I373	SEDE VALVOLA "POLIPROPILENE" SEAT VALVE "POLIPROPILENE"	4
I449	SEDE VALVOLA "SANTOPRENE" SEAT VALVE "SANTOPRENE"	4
M731	SFERA VALVOLA "ACETALICA" BALL VALVE "ACETALICA"	4
M732	SFERA VALVOLA "HYTREL" BALL VALVE "HYTREL"	4
M734	SFERA VALVOLA "PTFE" BALL VALVE "PTFE"	4
M760	SFERA VALVOLA "SANTOPRENE" BALL VALVE "SANTOPRENE"	4

KIT COMPLETO

TUTTE LE GUARNIZIONI (H...) MENZIONATE NELL'ESPLOSO SONO FORNIBILI ANCHE SINGOLARMENTE

COMPLETE KIT

ALL THE O-RING (H...) MENTIONED IN THE EXPLODED VIEW CAN BE SUPPLIED SEPARATELY

CODICE CODE	DESCRIZIONE DESCRIPTION	Q.TÀ QTY
KR33/54	KIT MEMBRANE + VALVOLE (solo per 3C1/16111NHH) DIAPHRAGM + VALVE KIT (only for 3C1/16111NHH)	1
KR33/64	KIT MEMBRANE + VALVOLE (solo per 3C1/16111HHH) DIAPHRAGM + VALVE KIT (only for 3C1/16111HHH)	1
KR33/65	KIT MEMBRANE + VALVOLE (solo per 3C1/16111TTP) DIAPHRAGM + VALVE KIT (only for 3C1/16111TTP)	1
KR33/207	KIT MEMBRANE + VALVOLE (solo per 3C1/16111EAA) DIAPHRAGM + VALVE KIT (only for 3C1/16111EAA)	1
KR33/208	KIT MEMBRANE + VALVOLE (solo per 3C1/16111SSS) DIAPHRAGM + VALVE KIT (only for 3C1/16111SSS)	1
KR33/209	KIT GUARNIZIONI DISTRIBUTORE ARIA AIR DISTRIBUTOR GASKETS KIT	1
KR33/210	KIT GUARNIZIONI CORPO MOTORE MOTOR GASKETS KIT	1

ART. KS

SET RICAMBI CONSIGLIATI

AI PUNTI VENDITA E ASSISTENZA, COMPOSTO DAI RICAMBI SOTTO ELENCATI

SPARE PARTS KIT ADVISED

TO THE REPAIR CENTERS. THIS KIT INCLUDES ALL THE SPARE PARTS SHOWN HERE UNDER

CODICE CODE	DESCRIZIONE DESCRIPTION	Q.TÀ QTY
KS33/100	KR33/209, KR33/210, KR33/54 (solo per/only for: 3C1/16111NHH)	1
KS33/101	KR33/209, KR33/210, KR33/64 (solo per/only for: 3C1/16111HHH)	1
KS33/102	KR33/209, KR33/210, KR33/65 (solo per/only for: 3C1/16111TTP)	1
KS33/103	KR33/209, KR33/210, KR33/207 (solo per/only for: 3C1/16111EAA)	1
KS33/104	KR33/209, KR33/210, KR33/208 (solo per/only for: 3C1/16111SSS)	1

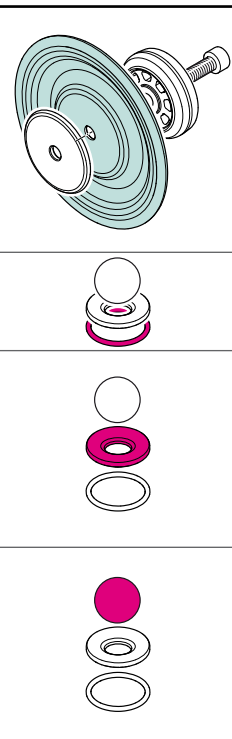

RAASM

ADVANCED FLUID MANAGEMENT SOLUTIONS